

Client _____ Quantity _____

Project _____ Position _____

Qubi oven

Model: QUBI6**Cod:** NP01064021001

Technical data

Number of pans:	6
Pans size (mm):	GN 1/1
Tray centre distance (mm):	70
Number of fans:	1
Fan speed:	17
Dimensions (mm):	900 x 850 x 840
Net weight (kg):	135
Volume (m3):	0,643
Chamber size (mm):	410 x 680 x 470
Electric power (kW):	14,1
Voltage (V):	380-415
Power supply (A):	30,5
Phases:	3N
Cable section (mmq):	5G6
Frequency (Hz):	50-60
Cold water connection:	3/4"
Softened water inlet:	3/4"
Drain size (mm):	50
Packing dimensions (mm):	955 x 925 x 1077
Chamber size (mm):	410 x 680 x 470
Gross weight (kg):	145
Gross volume (m3):	0,951

Features

Oven type:	Combi
Control:	Touch screen
Touch screen:	7"
Functions:	Cottura Dry, vapore, mista, mantenimento, essiccazione, multilivello, cottura lenta, cottura delta T, finishing, rigenerazione, pastorizzazione
Cooling:	Rapid chamber cooling function
Probe:	Standard - multipoint core probe
Washing:	Standard - Closed Circuit
Detergent:	Liquid single-dose
Steam:	Direct + indirect
Steam management:	Double Steam Balance
Boiler:	Standard
Temperature range:	30°C - 300°C
Door:	Hinged door
Range timer:	1'-24h
Flue:	Automatic
Recipes:	Standard
Wifi connection:	Standard

Cosmo

Cosmo is the innovative wi-fi technology that allows you to connect cooking, blast chilling and storage appliances to each other and remotely monitor them. Thanks to Cosmo you can manage the entire kitchen from your smartphone and be sure that all devices

Technical draw

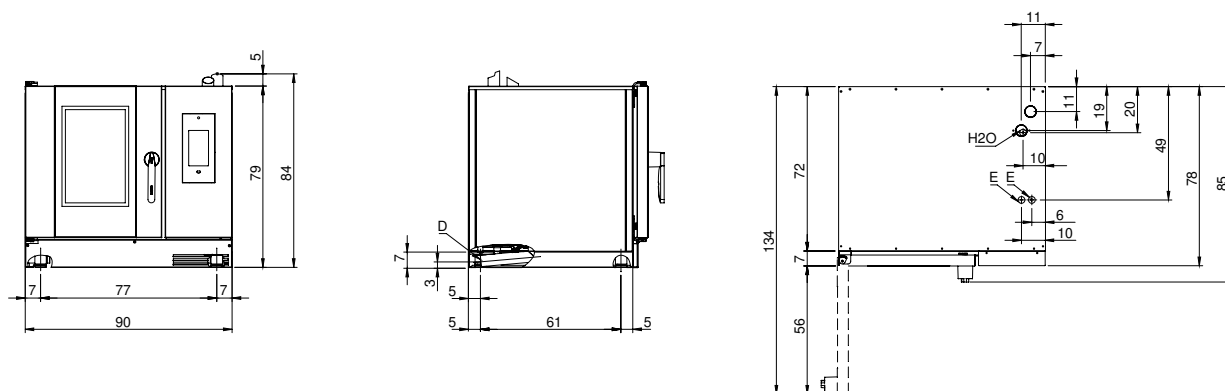

E: Electric connection

D: Drain for water

H2OA: Water inlet